

Public Meeting #1 for Blackstone McKinley Burlington Northern Santa Fe (BNSF) Railroad Grade Separation Project



Wednesday, March 30, 2022

6:00 PM to 7:30 PM

Presentation to start at 6:05 pm

Instructions for Interpretive Services at 6:00 pm



Tonight's Agenda

2

- Opening Remarks- Mayor Dyer and Public Works Director Mozier
- Housekeeping
- Virtual Room Demonstration
- Preliminary Design
- Aesthetic Themes & Survey
- Stage Construction Options & Survey
- Project Schedule
- Questions and Answers

Mayor's Welcome

3



ge Construction

Grade Separation

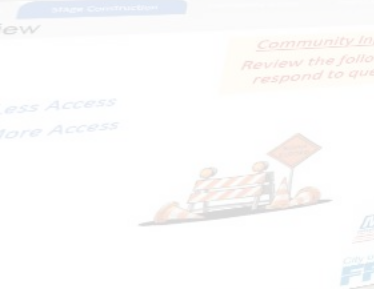

Public Works Director Remarks

4



ge Construction

Grade Separation

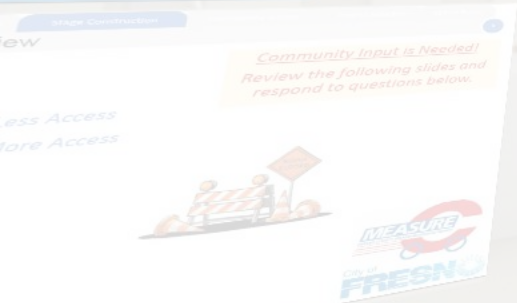

Housekeeping

5

- Meeting is being recorded for posting to City website.
- Presentation should last about 45 minutes.
- Audio/Video is Disabled During Presentation.
- Ask Questions

— During the Presentation, you can use the Q & A button to ask questions

These will be answered during Questions and Answers Session

- Attendees that want to discuss specific items that affect only their property or business to request a follow-up meeting along with a contact number and email address in the Q & A button.

Project Background

6

- Safety and Operational Challenges
 - 4 Pedestrian/Motorist Fatalities in last 10 years
 - 2 min. 48 sec. Average Daily Delay for each Motorists
 - Pedestrian Delay
 - Business Access
- Gap in Train Horn Quiet Zones
- Project Funding
 - Fresno County Transportation Authority (Measure C) Funding

Project Benefits

7

- Project Benefits
 - Eliminate 2 at-grade crossings
 - Eliminate pedestrian/vehicle – train conflicts
 - Improved safety and operations
 - Decrease traffic interruptions, increase travel reliability
 - No train horns at these 2 at-grade crossings
 - Redevelopment opportunity
 - Aesthetic treatment opportunity

Railway Shoofly

8

- BNSF Railway Shoofly-
A temporary rail alignment

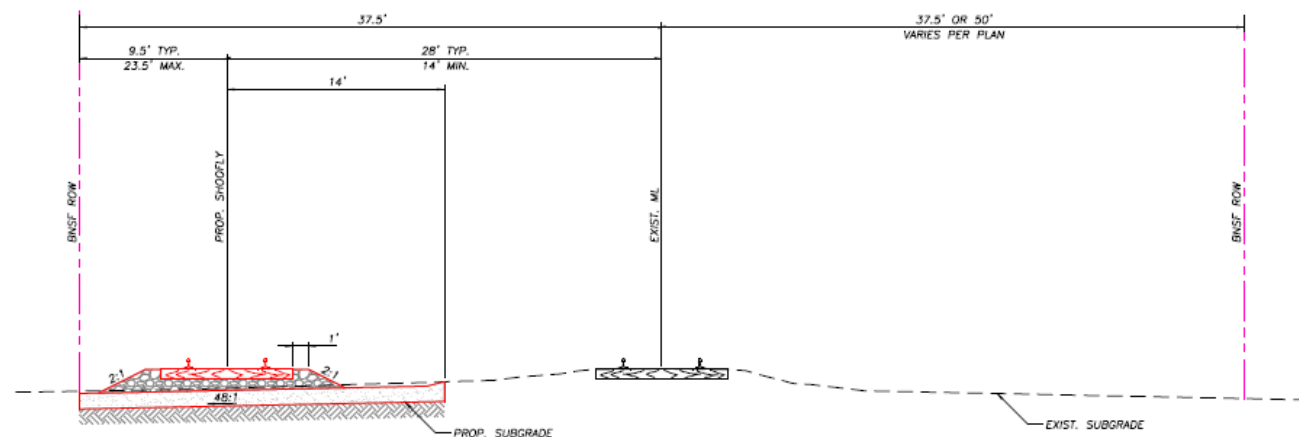

TYPICAL SECTION



LAYOUT

Roadway Typical Section

9

- Blackstone Avenue

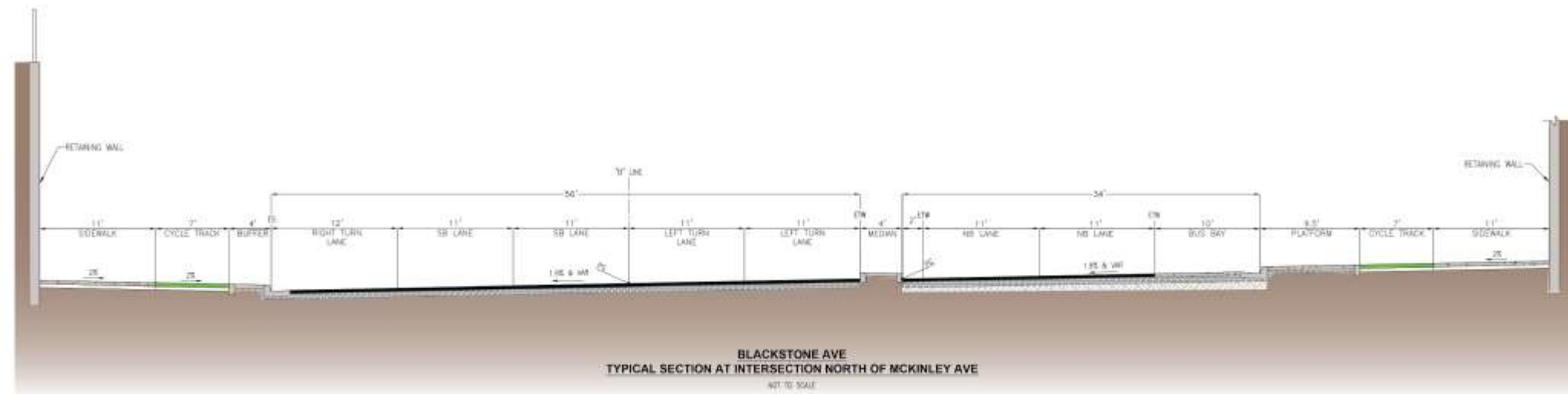
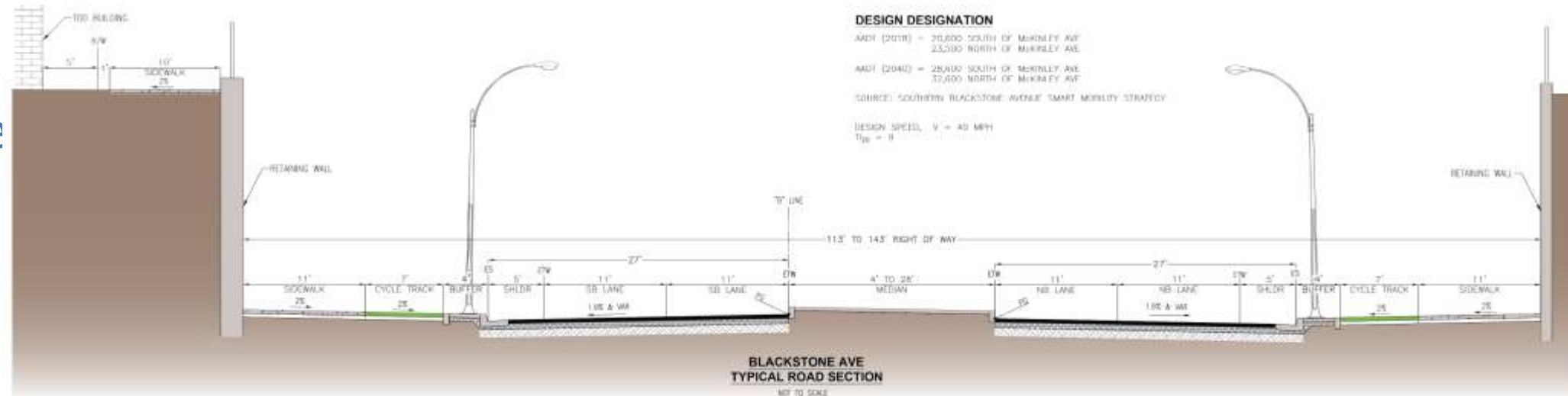

Roadway Profile

10

- Blackstone Avenue

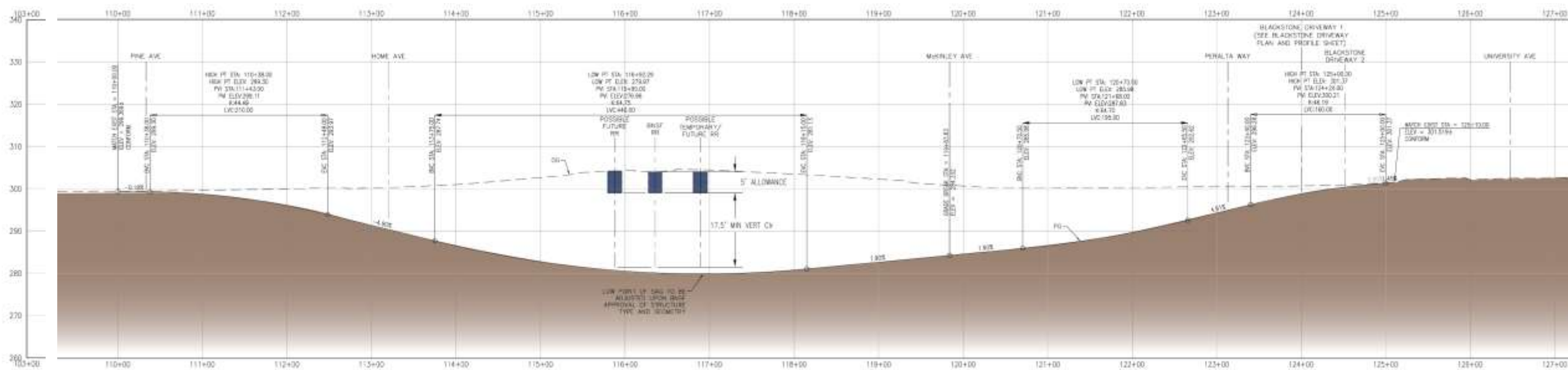

Roadway Layout

11

- Blackstone Avenue



Here's what it could look like:

12



Bridge Plan & Elevation

13

- Blackstone Avenue

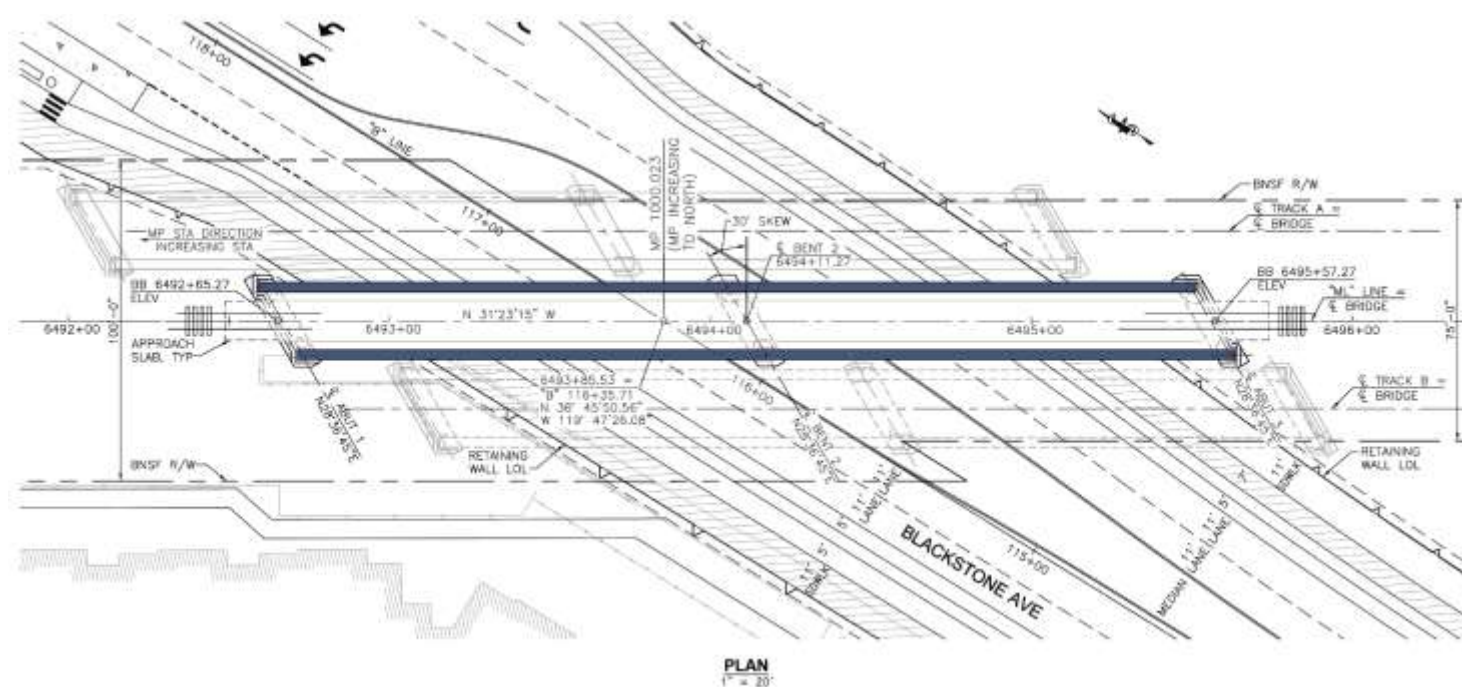
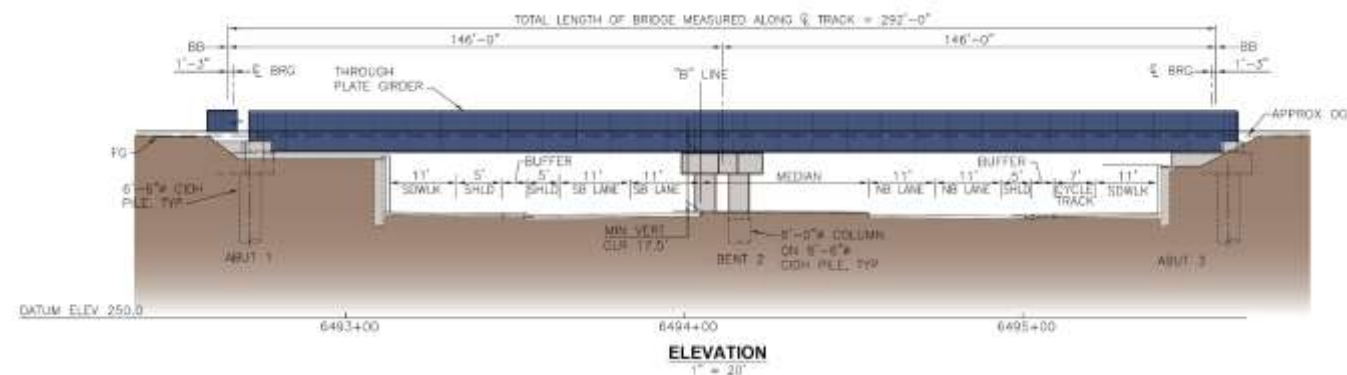

Bridge Typical Section – Through Girder

14

• Blackstone Avenue

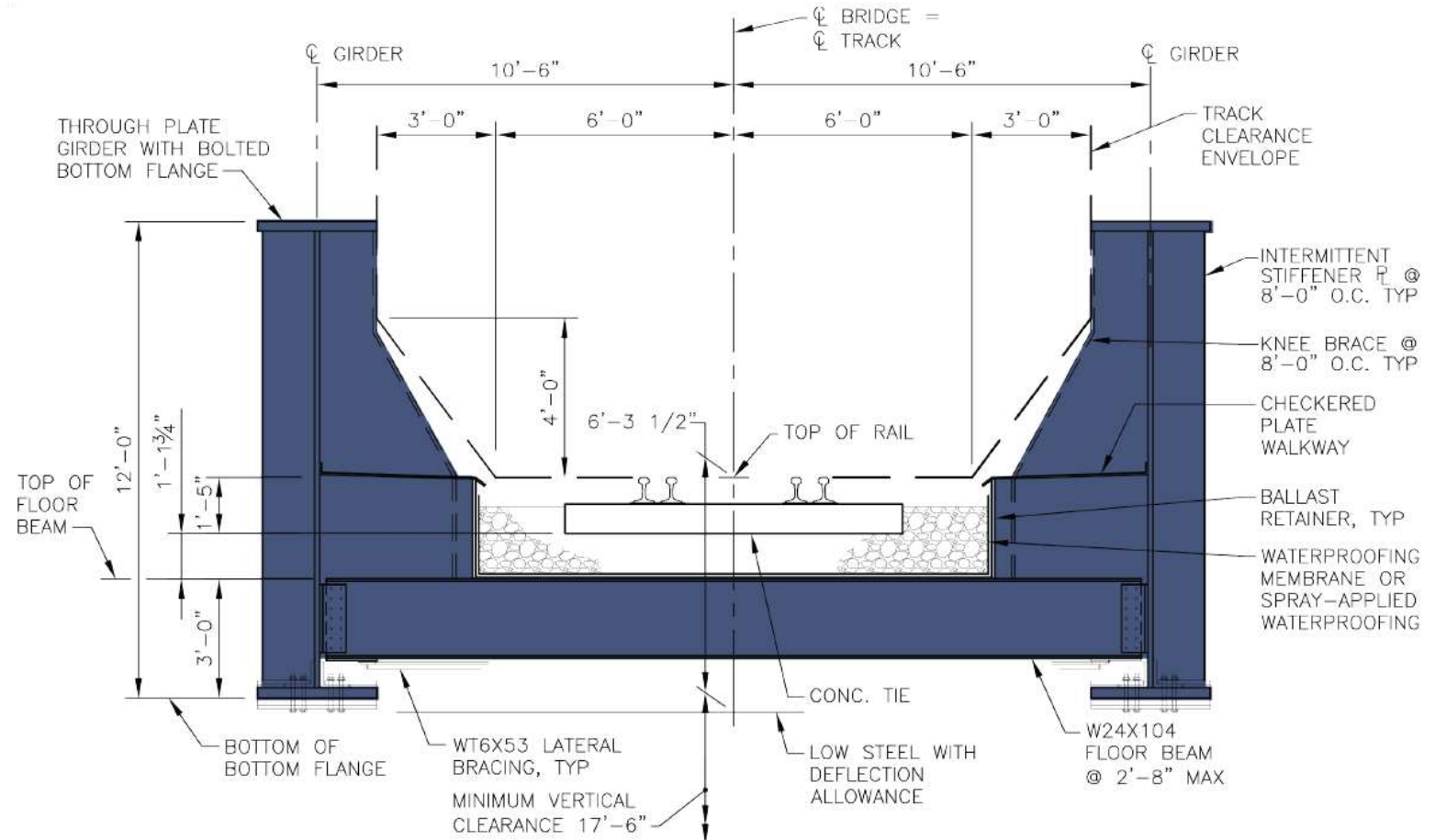

TYPICAL SECTION

3/8" = 1'-0"

Roadway Typical Section

15

- McKinley Avenue

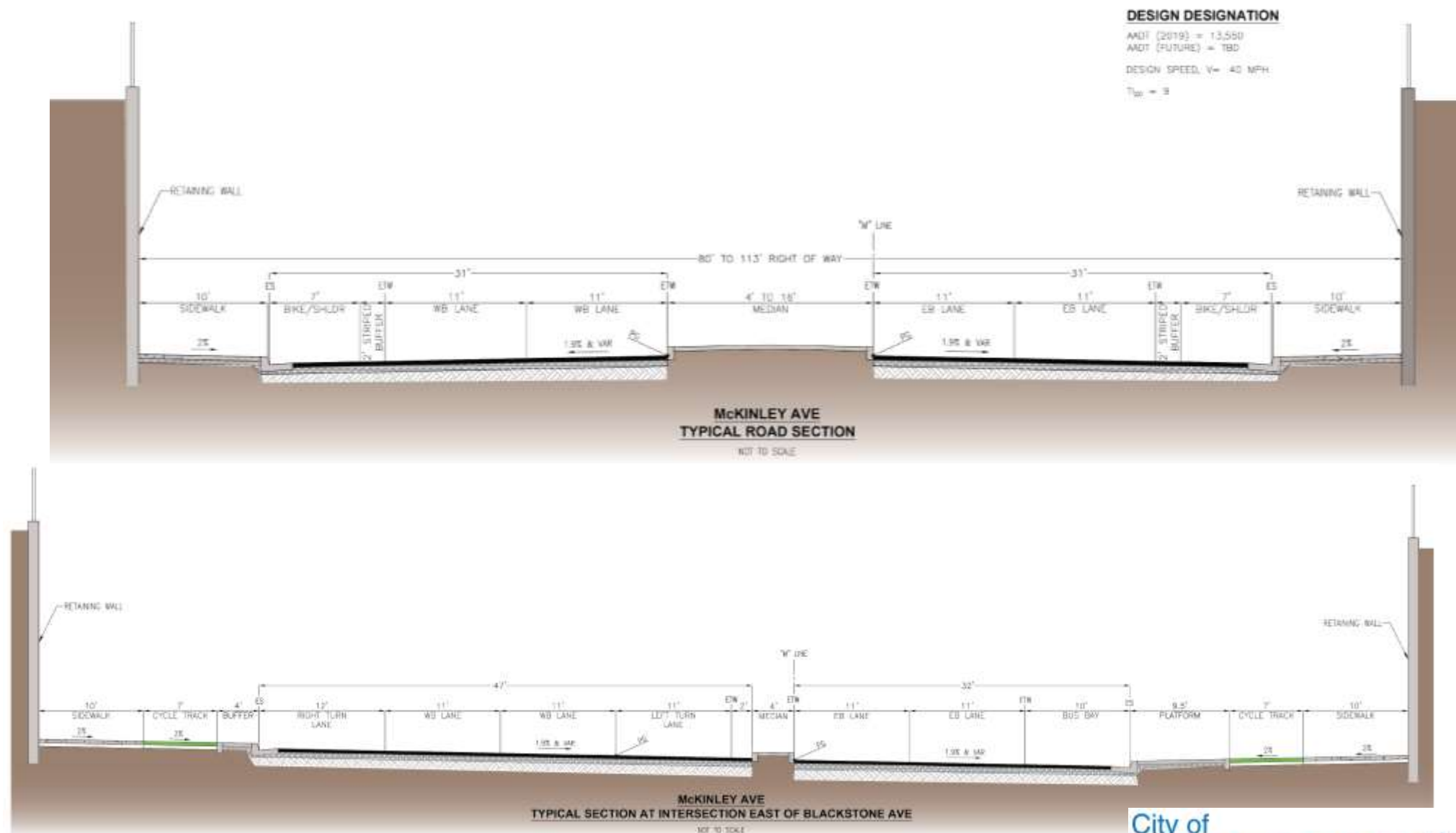

Roadway Profile

16

- McKinley Avenue

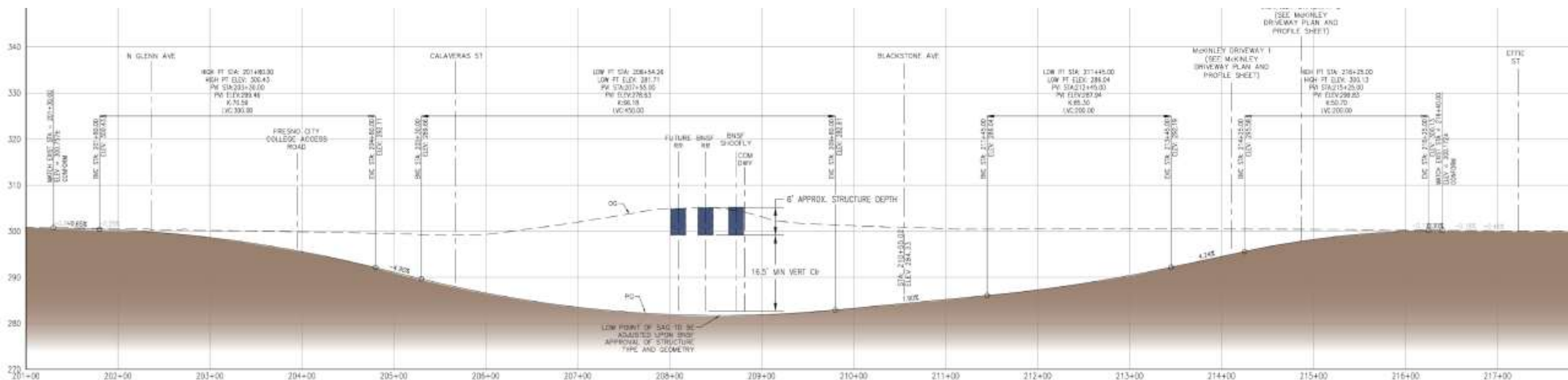

Roadway Layout

17

- McKinley Avenue

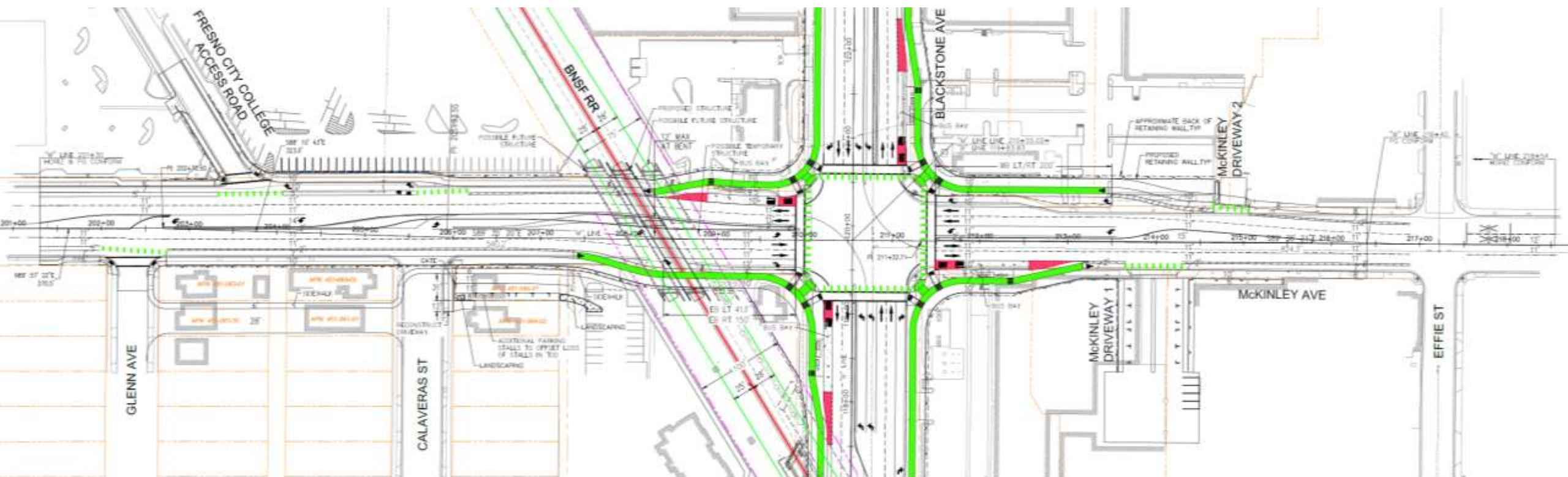

Bridge Plan & Elevation

18

- McKinley Avenue

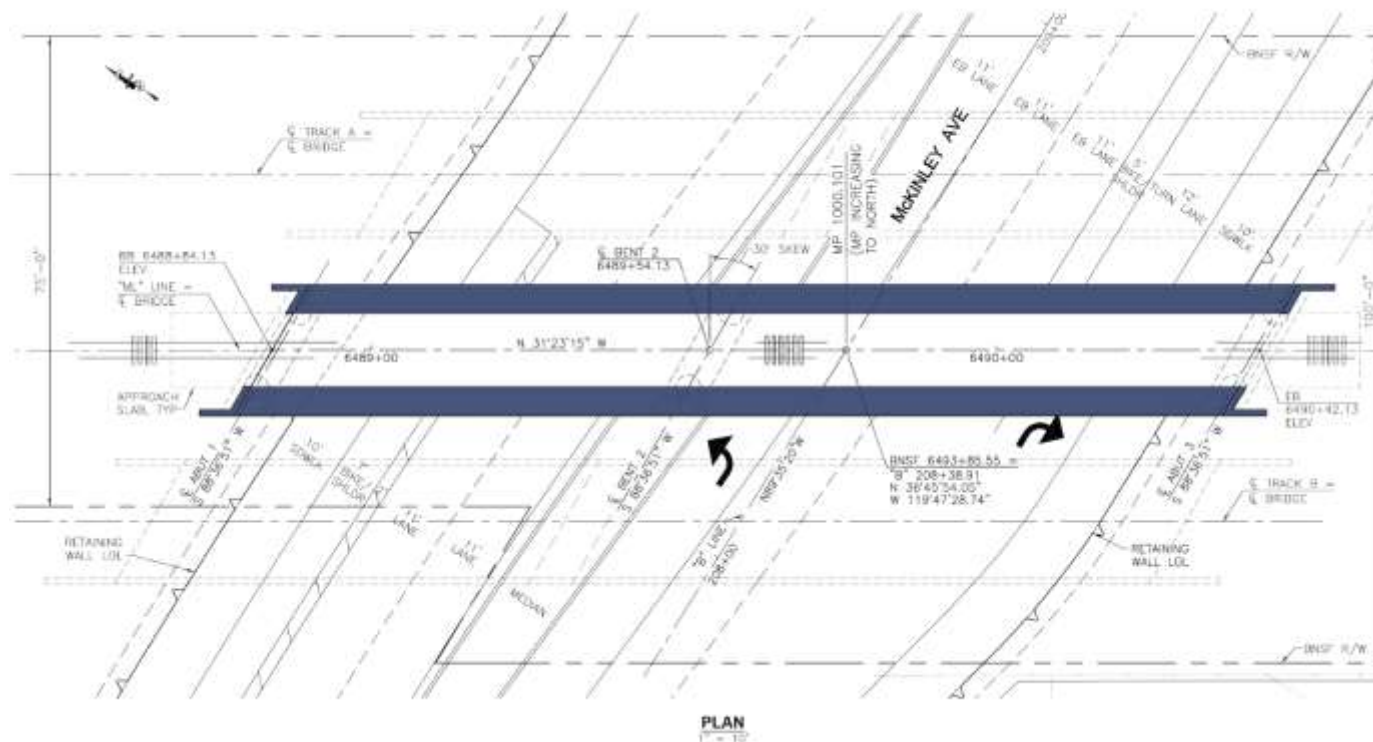
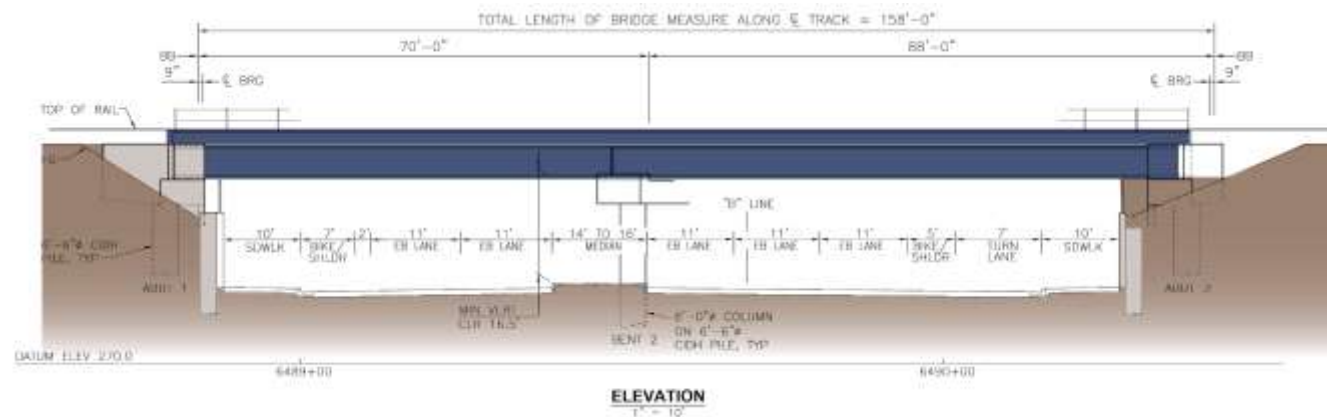

Bridge Typical Section – Deck Girder

19

- McKinley Avenue

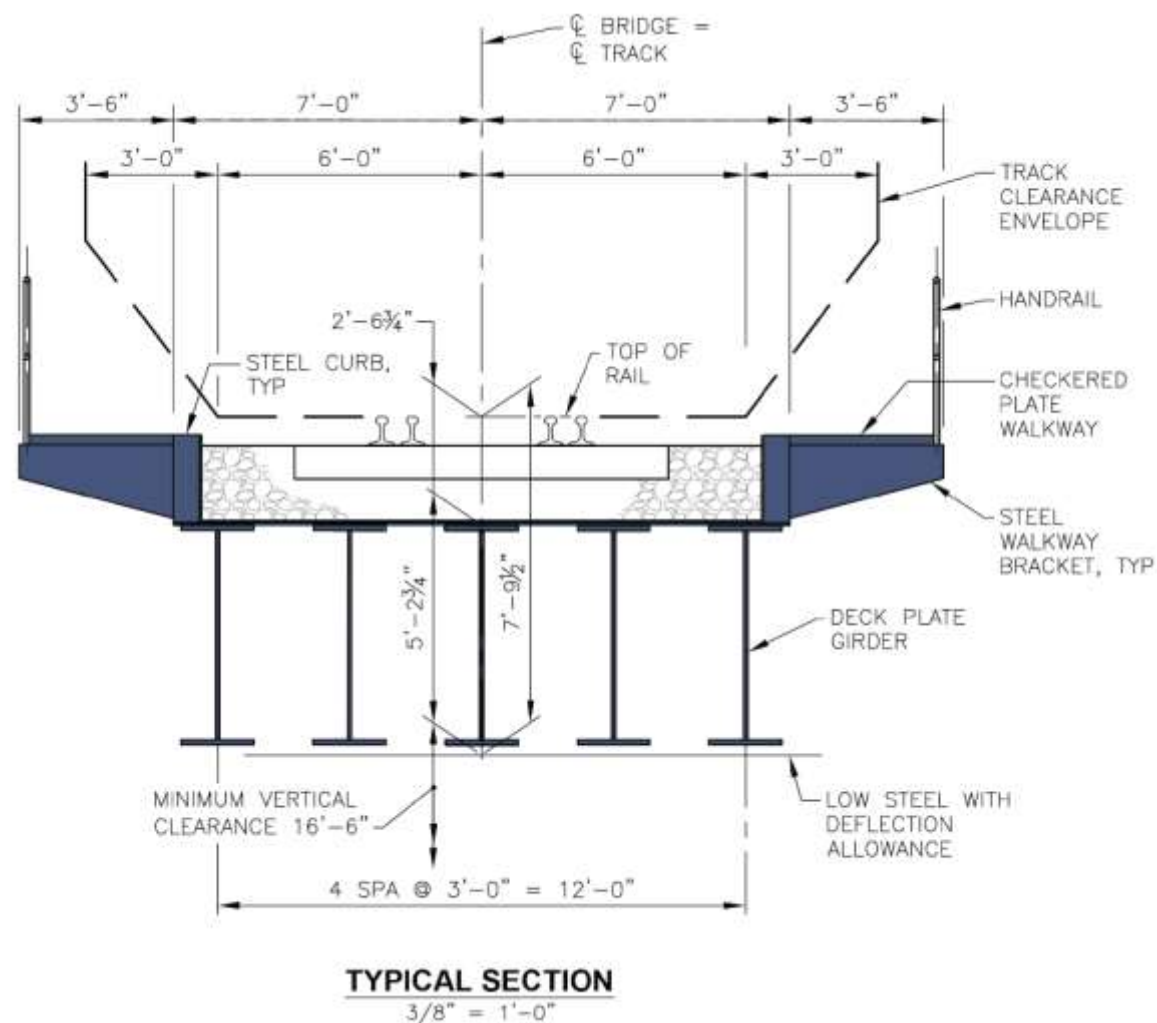

Utilities

20

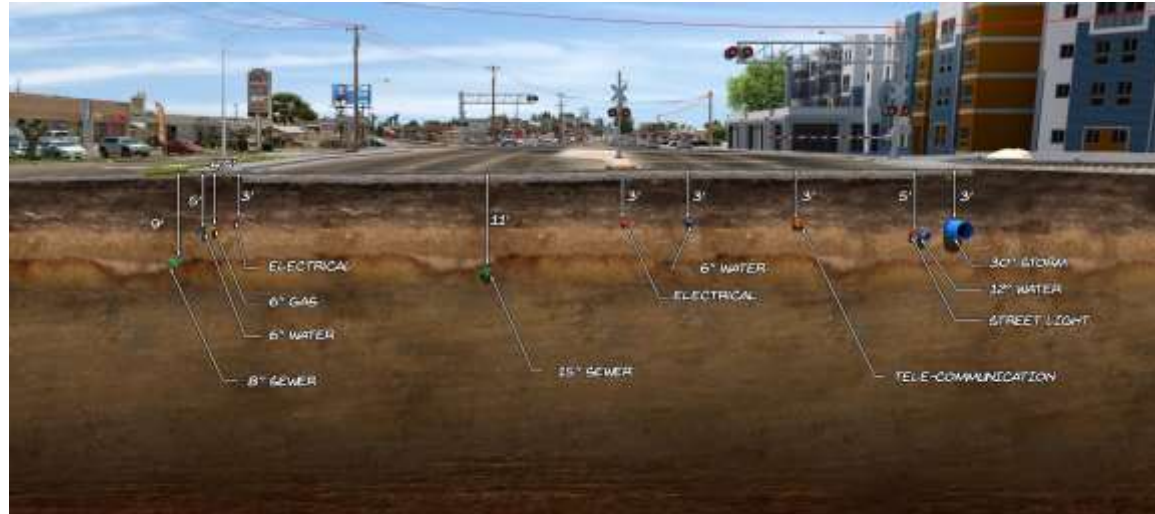

Project Schedule- Key Milestones

21

- Complete Design – Spring 2024
- Complete Acquisition of Right of Way – Summer 2024
- Start Construction – Fall 2024
- Complete Construction- Fall 2027
- Advanced Utility Relocation may occur where possible.



Questions and Answers Session

- *The City and Consultant Team will answer as many of the questions as possible in the remaining time.*
- *The questions will be synthesized where possible. If we missed the essence of your question, please ask it again.*
- *We request attendees that want to discuss specific items that affect only their property or business to request a follow-up meeting along with a contact number and email address in the Q & A button.*
- *Within 10 days, the City will post Frequently Asked Questions with Responses*